



REFERENCE:
E1233-A

METAL SOCKET 24V N

TECHNICAL SPECIFICATIONS:

- type N
- 7 pin 12V,
- aluminium housing
- carton dimension: 420x320x260mm,
- 100 pcs in bulk box
- socket weight: 188g

WARNING AND INSTALLATION INSTRUCTIONS:

- Use in accordance to the purpose.
- Install only in specialized workshops or professional services.
- The connector is used to connect the pneumatic brake system of the vehicle with the trailer system.



www.myKAMAR.com

PHOTO:

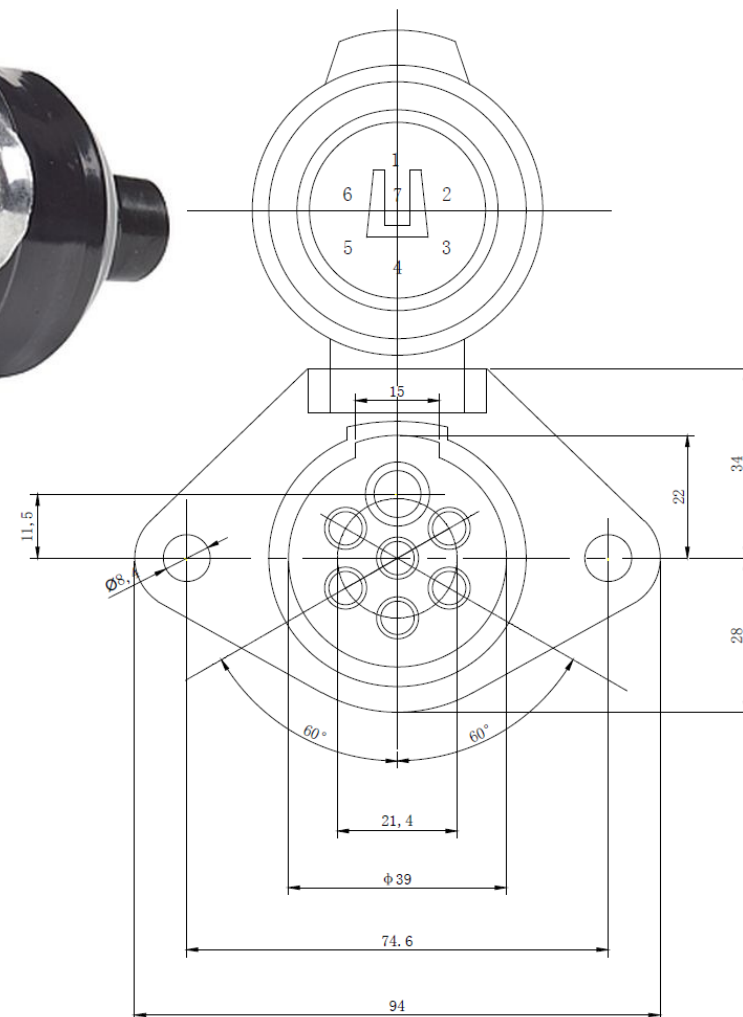

MARK	FUNCTION
L	Left Turn Signal
31	Ground connected
R	Right Turn Signal
58R	Tail lamps, right side
54	Stop lamps
58L	Tail lamps left side
7 pin	Trailer brake control